

Escalera Multi-Tramos

Contra Huella : 20.68 cm

Cantidad de Escalones : 14

Huella de Escalon : 22.66 cm

Altura a subir : 289.5 cm

Paso : 64.02 cm

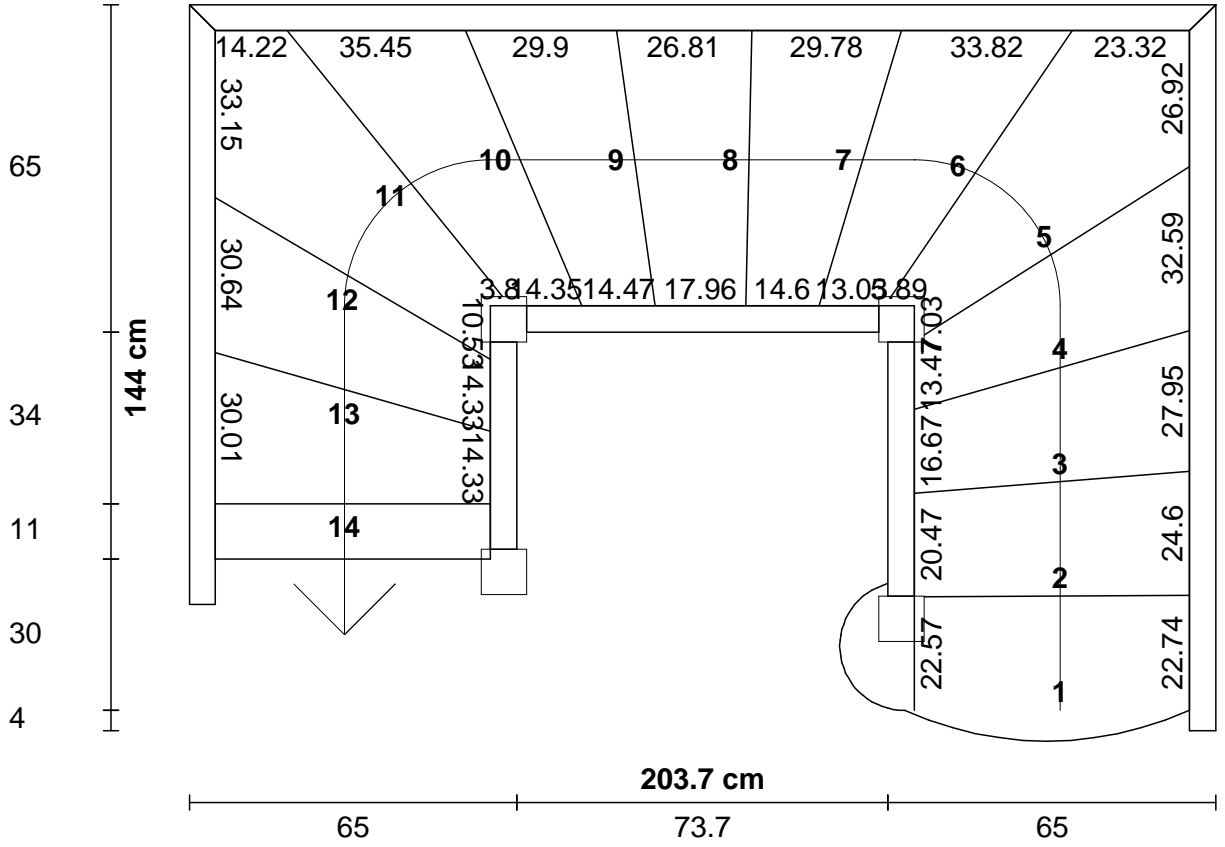

Escalon : 71.68 x 31.85

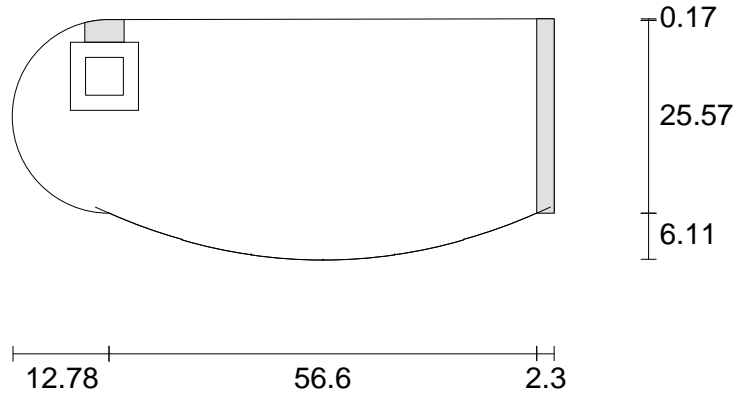

Escalon : 58.98 x 27.61

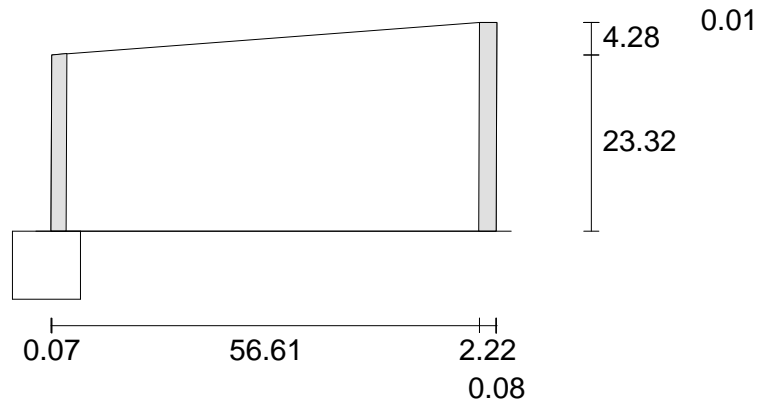

Escalon : 61.49 x 30.98

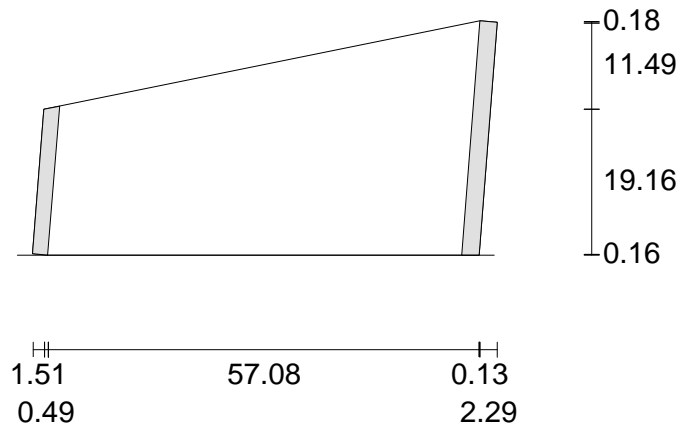

Escalon : 70.84 x 34.75

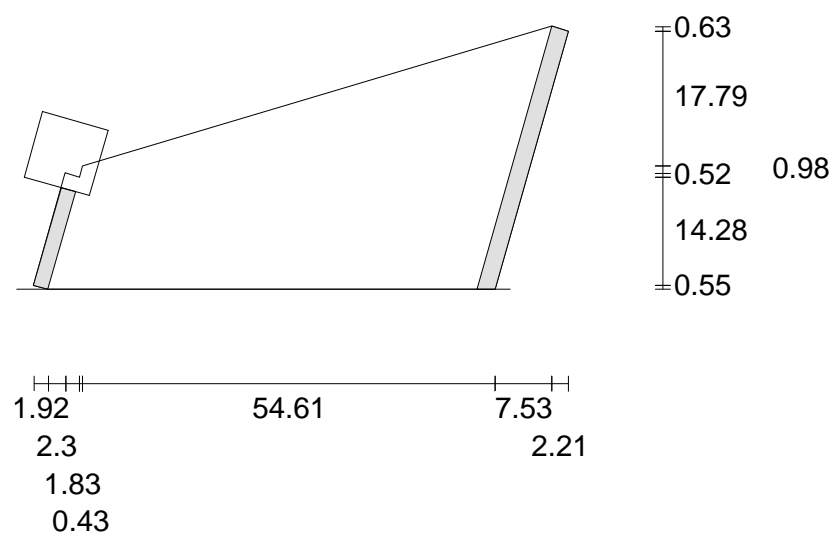

Escalon : 87.65 x 38.28

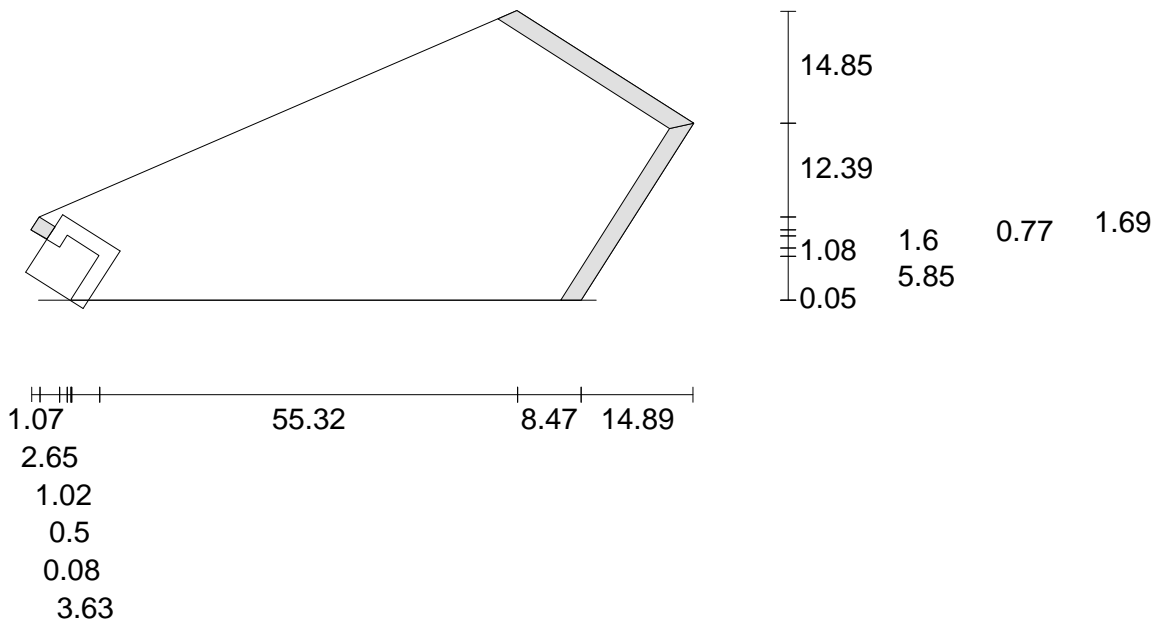

Escalon : 78.7 x 31.27

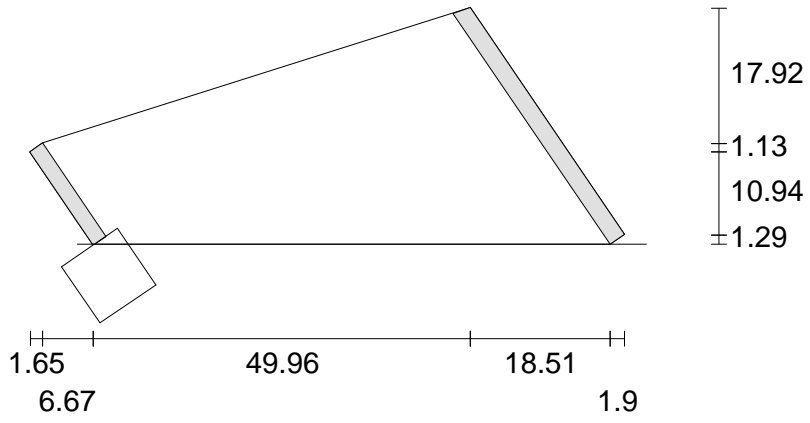

Escalon : 66.18 x 32.01

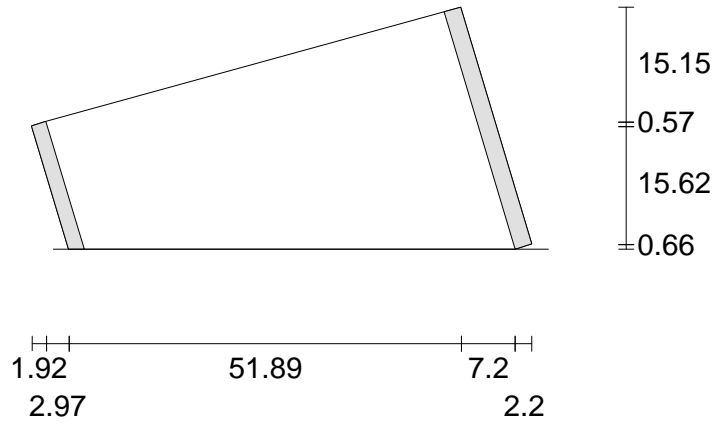

Escalon : 59.36 x 29.88

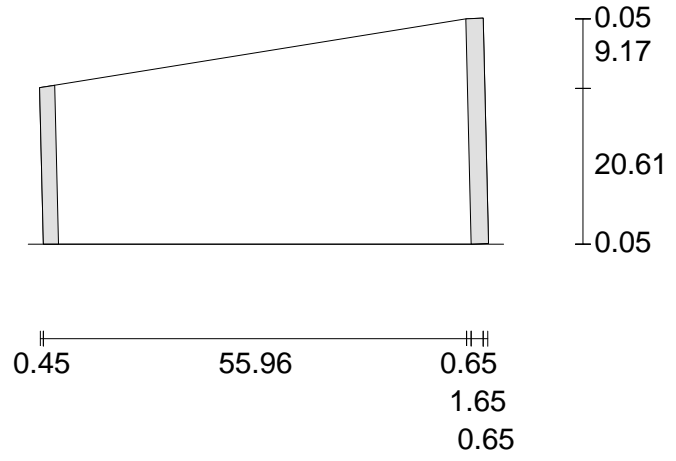

Escalon : 64 x 32.83

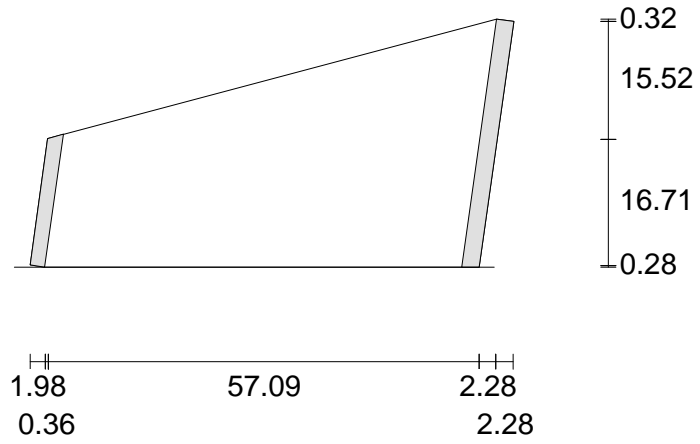

Escalon : 78.55 x 36.2

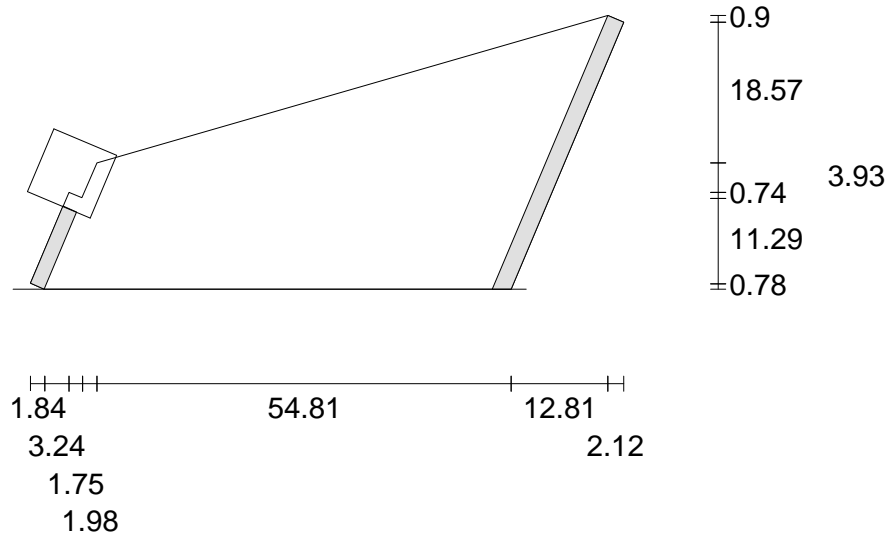

Escalon : 92.17 x 35.03

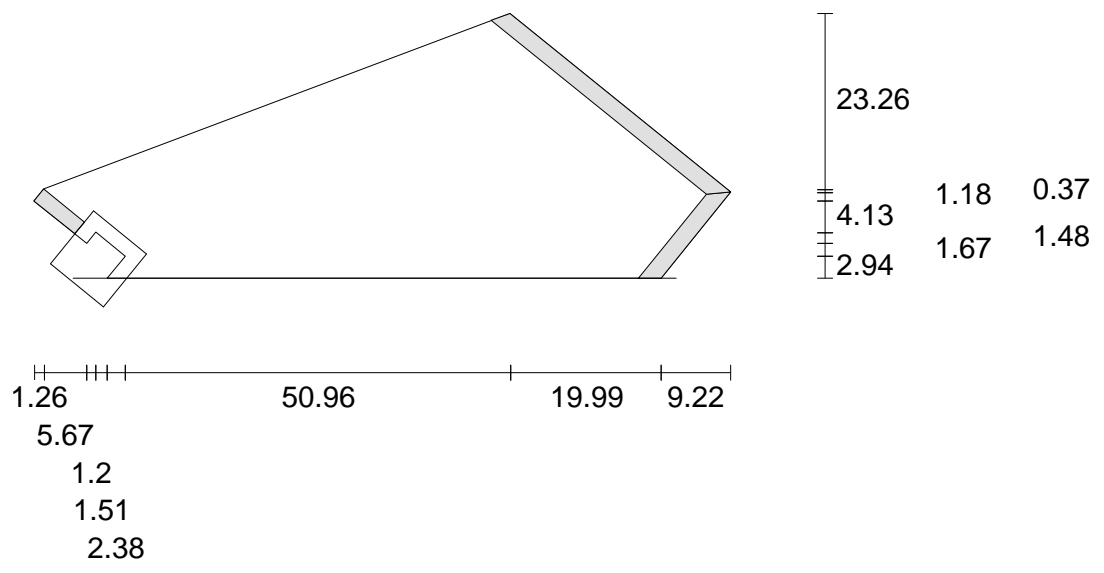

Escalon : 75.81 x 29.72

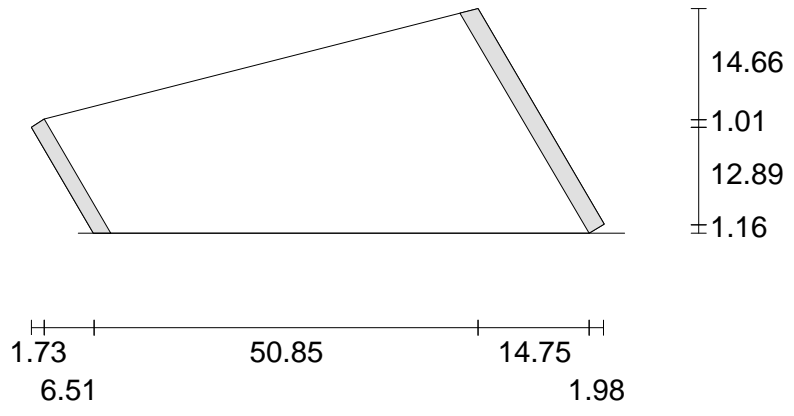

Escalon : 65.72 x 32.37

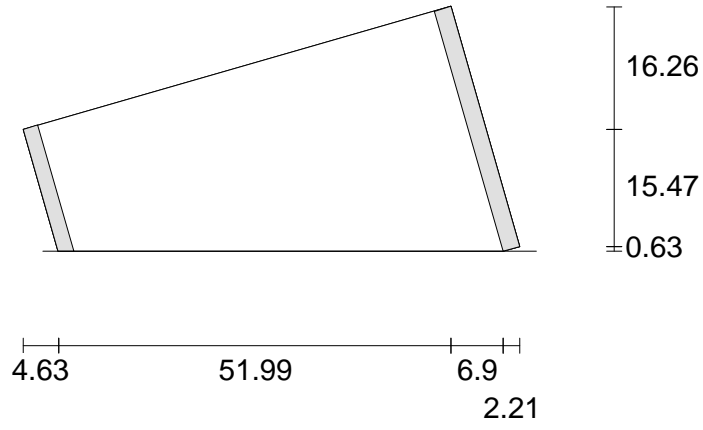

Escalon Rellano

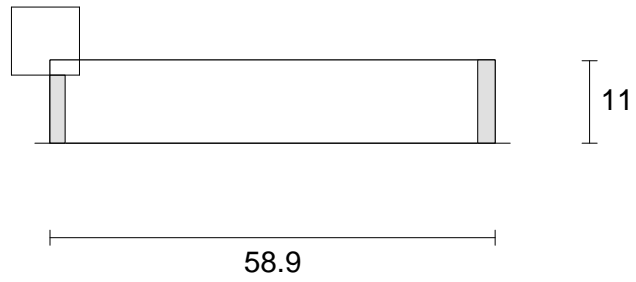

Dimensiones : 115.22 x 28 (51.1°)

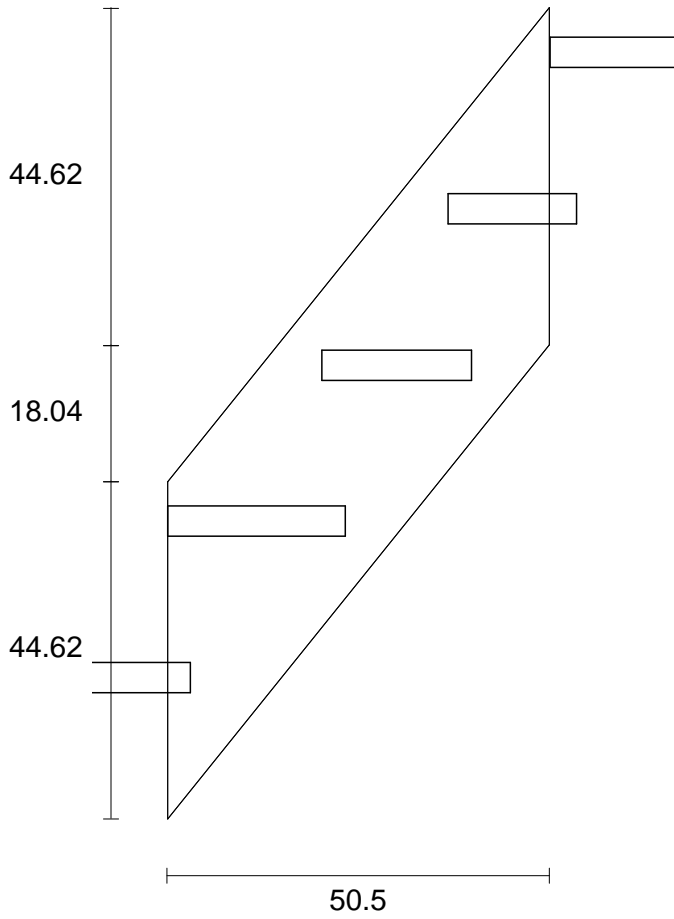

Dimensiones : 150.86 x 28 (52.4°)

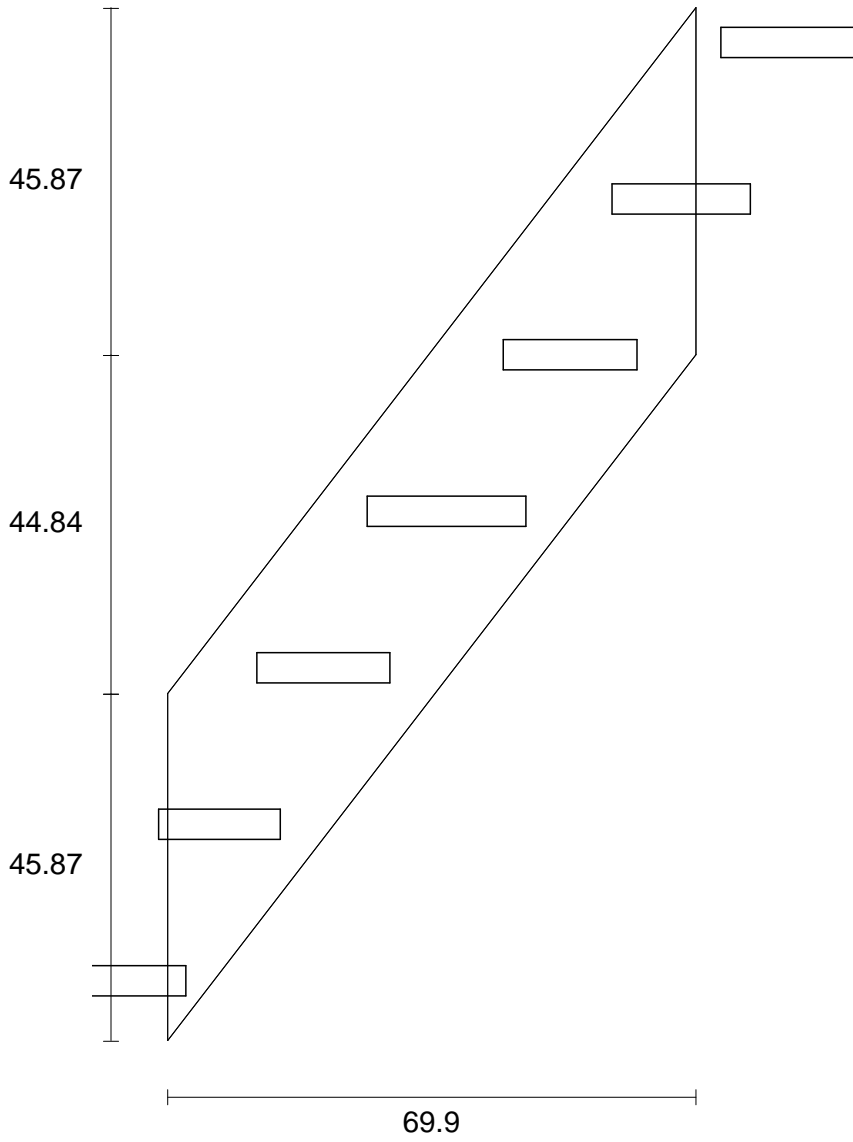

Dimensiones : 112.54 x 28 (55.3°)

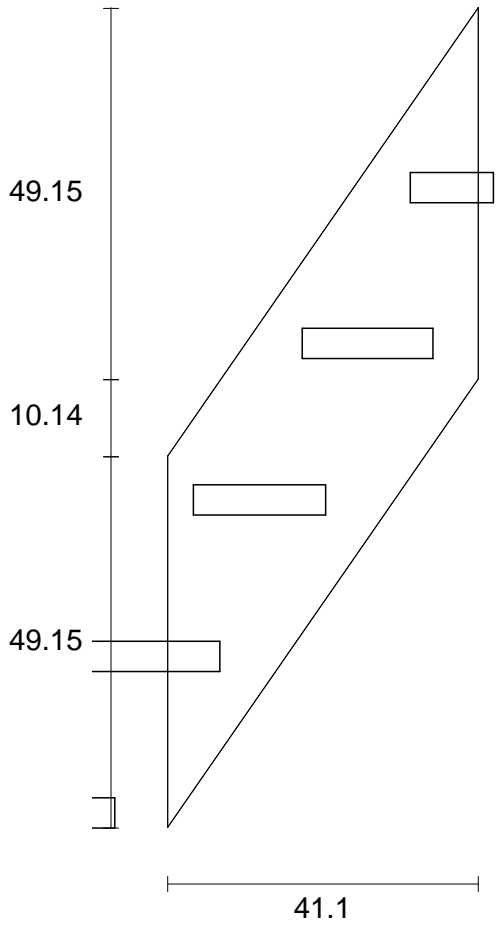

Dimensiones : 538.47 x 41.07 (32.2°)

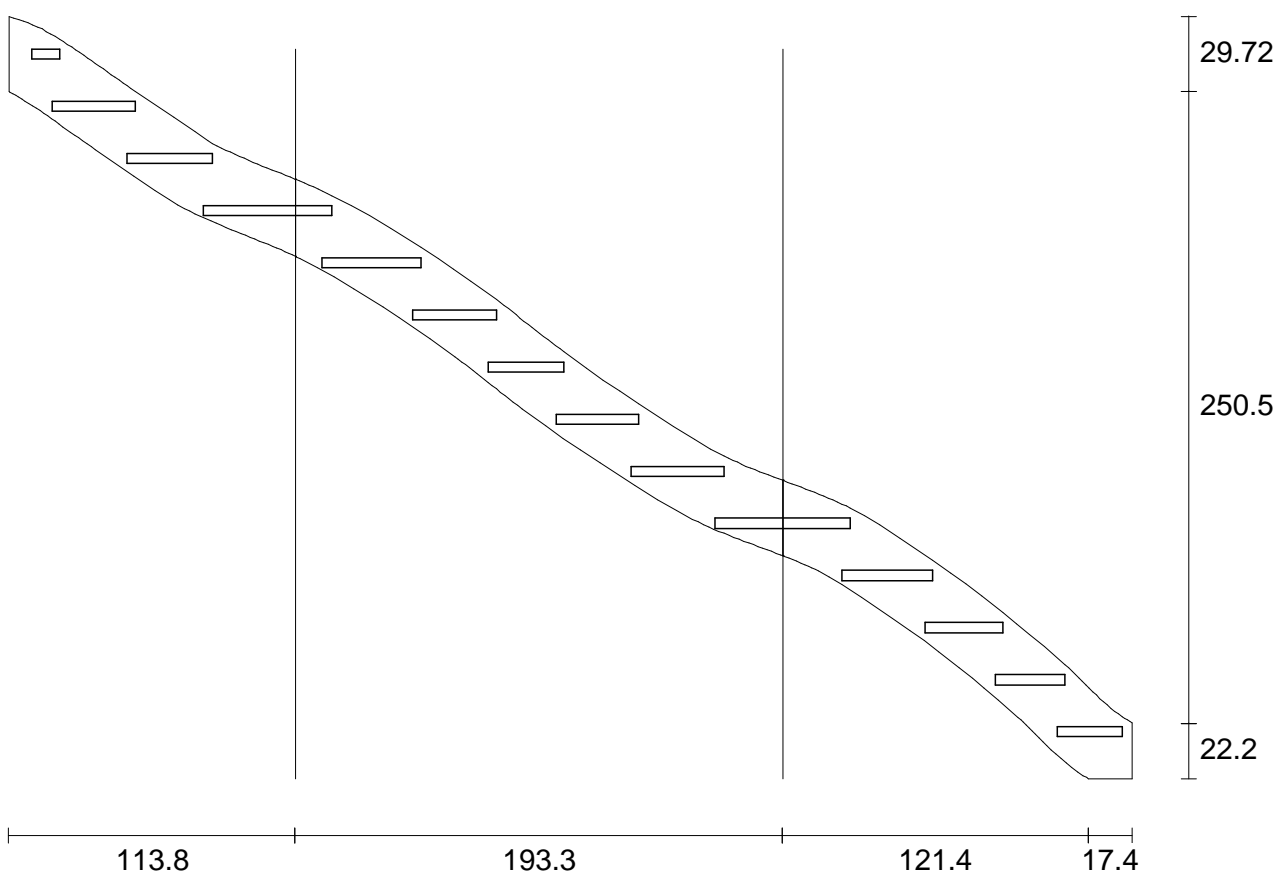

Pilar de Extremidad Zanca Izquierda Tramo : 1

Vista superior

Altura : 131.67

Escalon 1 Altura : 20.68

Escalon 2 Altura : 41.36

Cara 2 : Zanca : 51.13 Pasamanos : 51.13

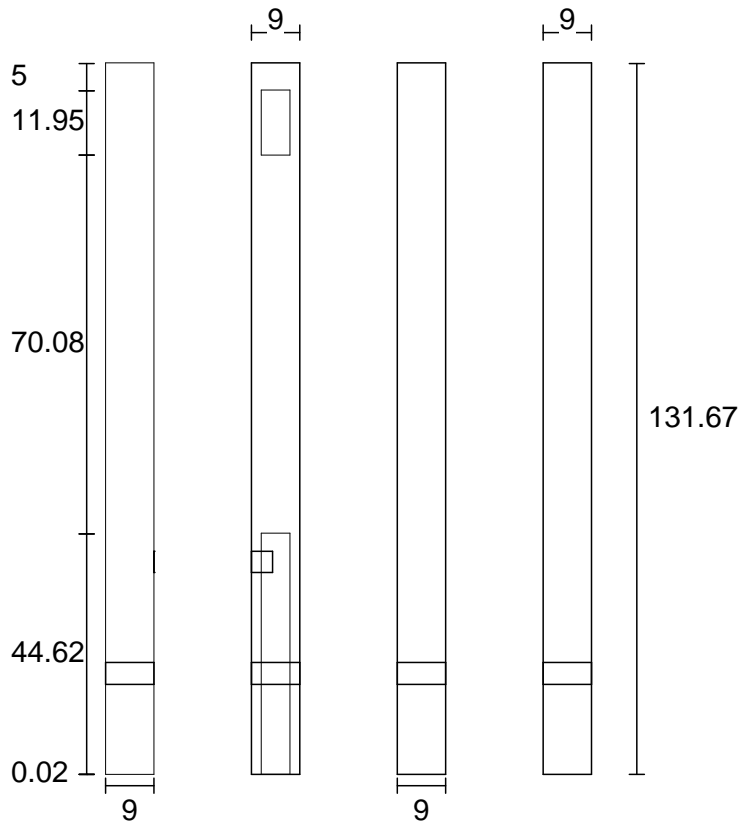

Pilar de Esquina Zanca Izquierda Tramo : 1-2

Vista superior

Altura : 167.2

Angulo : 90.00

Escalon 4 Altura : 25.03

Escalon 5 Altura : 45.71

Escalon 6 Altura : 66.39

Cara 3 : Zanca : 52.38 Pasamanos : 52.38

Cara 4 : Zanca : 51.13 Pasamanos : 51.13

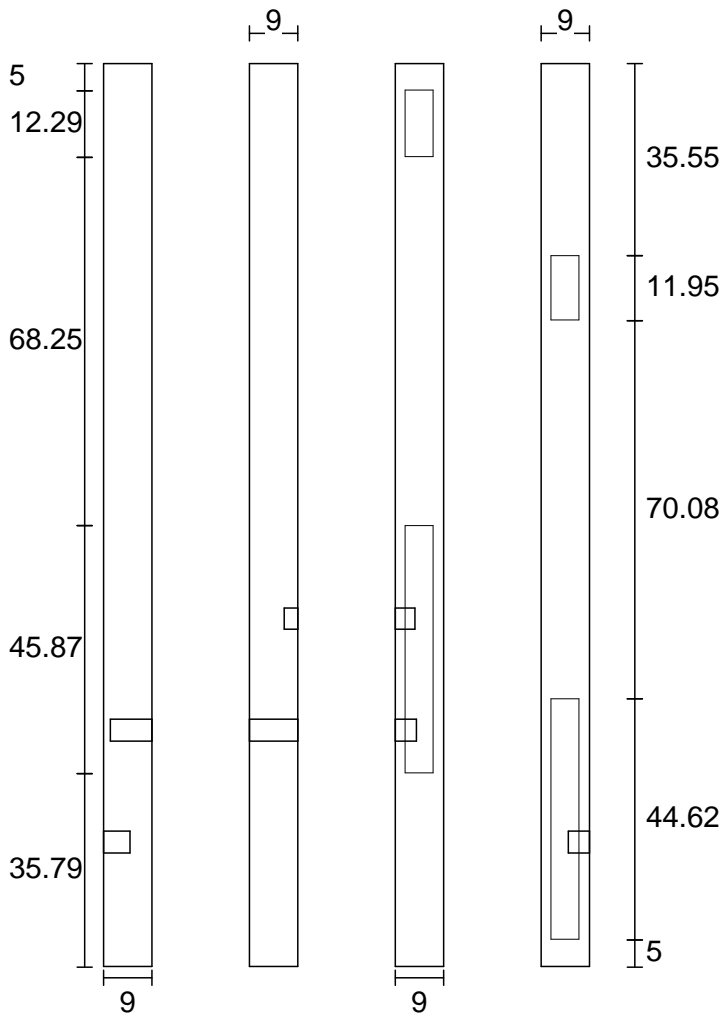

Pilar de Esquina Zanca Izquierda Tramo : 2-3

Vista superior

Altura : 159.01

Angulo : 90.00

Escalon 10 Altura : 27.61

Escalon 11 Altura : 48.28



Cara 3 : Zanca : 55.27 Pasamanos : 55.27

Cara 4 : Zanca : 52.38 Pasamanos : 52.38

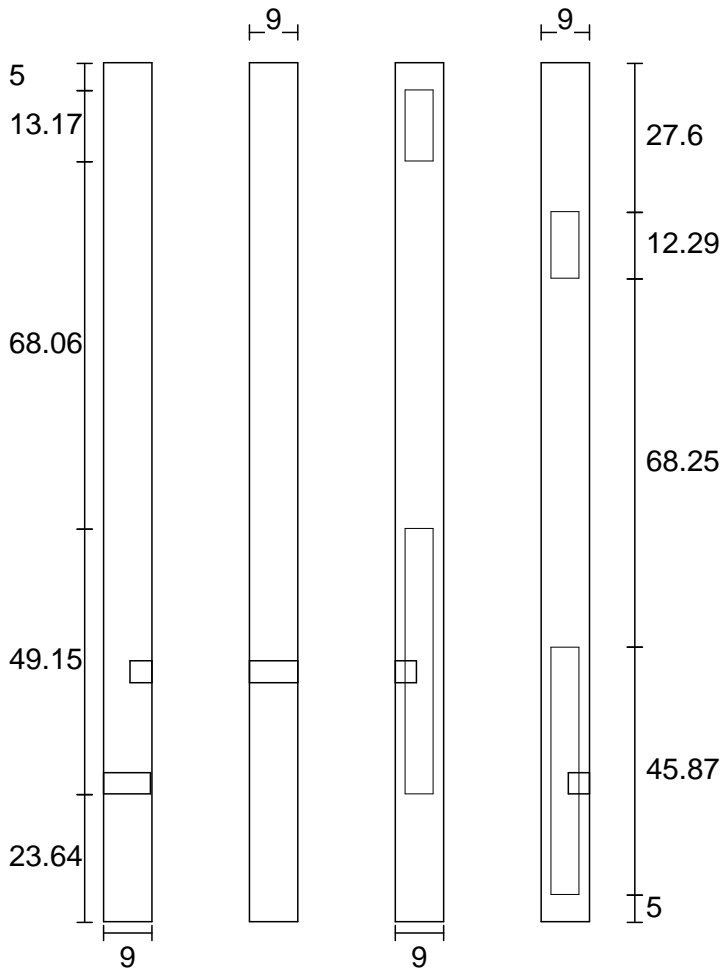

Pilar de Extremidad Zanca Izquierda Tramo : 3

Vista superior

Altura : 140.37

Escalon 14 Altura : 32.39

Cara 4 : Zanca : 55.27 Pasamanos : 55.27

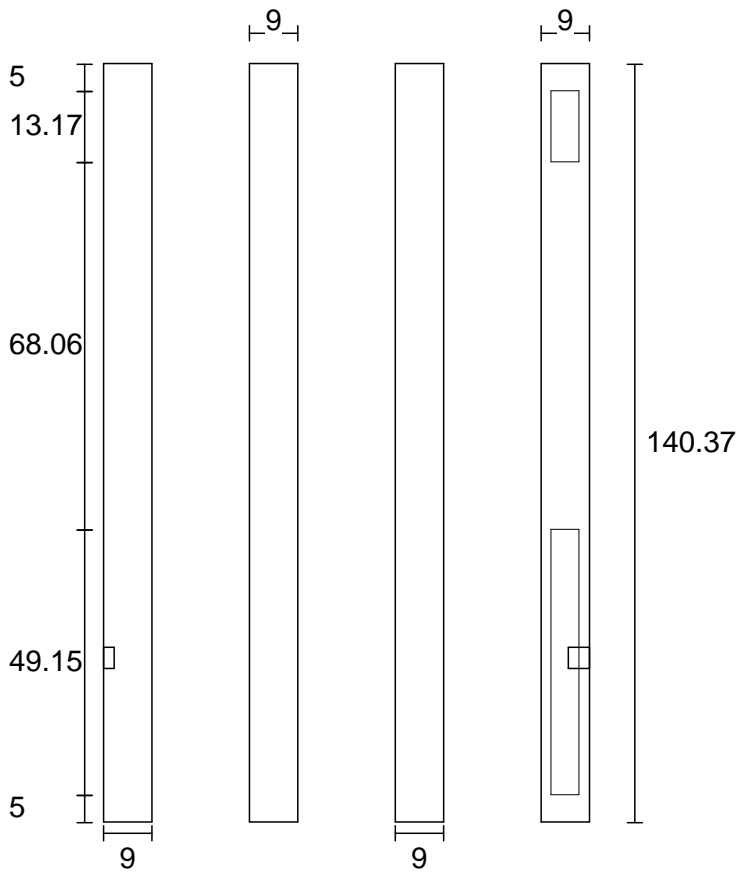

Dimensiones : 89.78 x 7.5 (51.1)

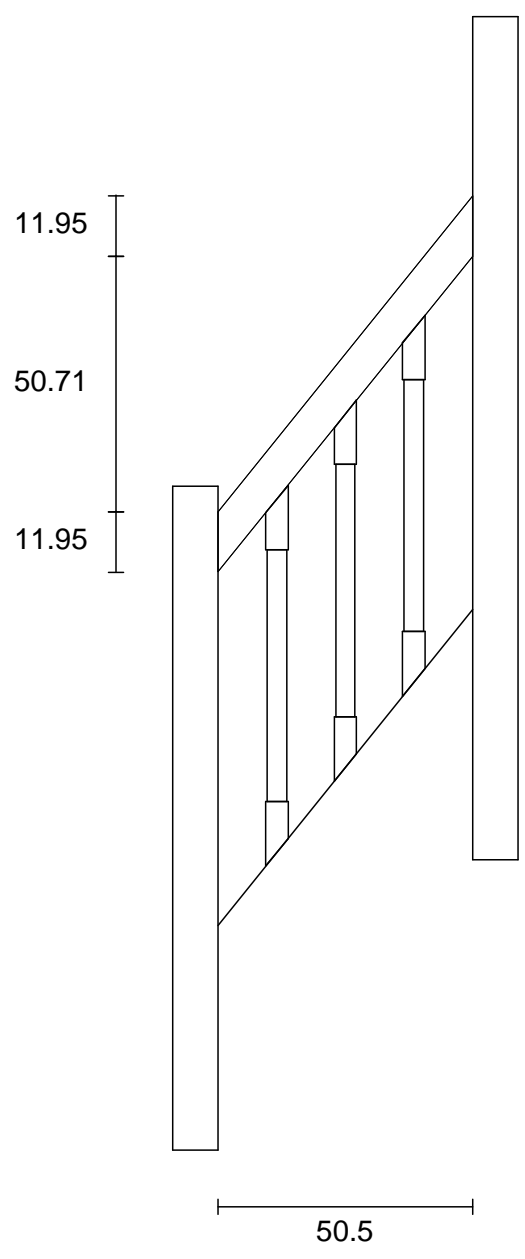

Dimensiones : 124.25 x 7.5 (52.4°)

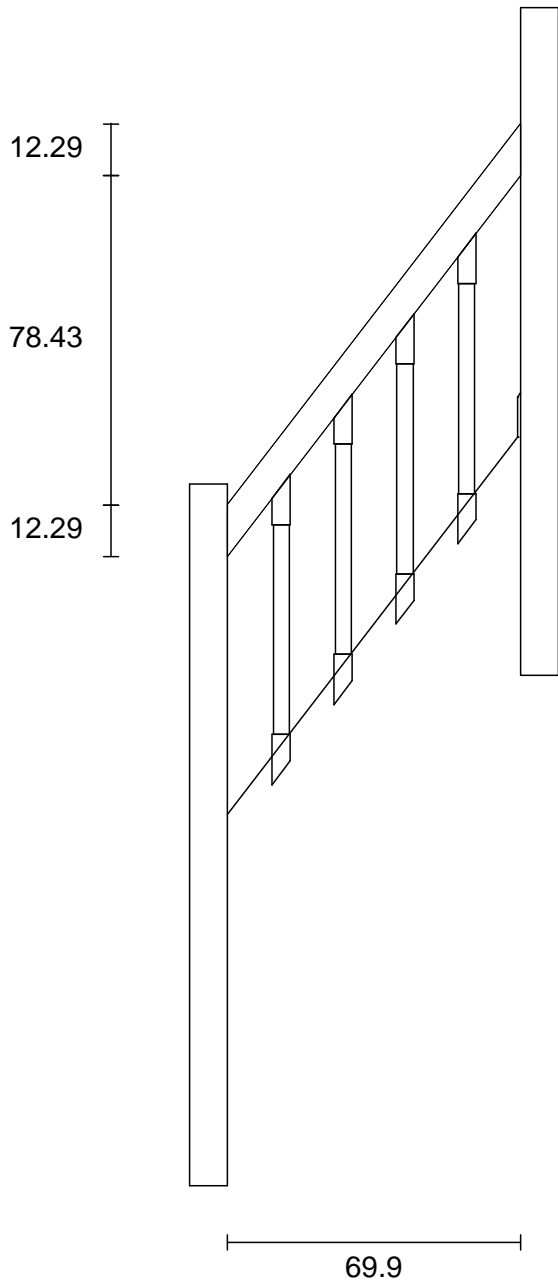

Dimensiones : 82.96 x 7.5 (55.3)

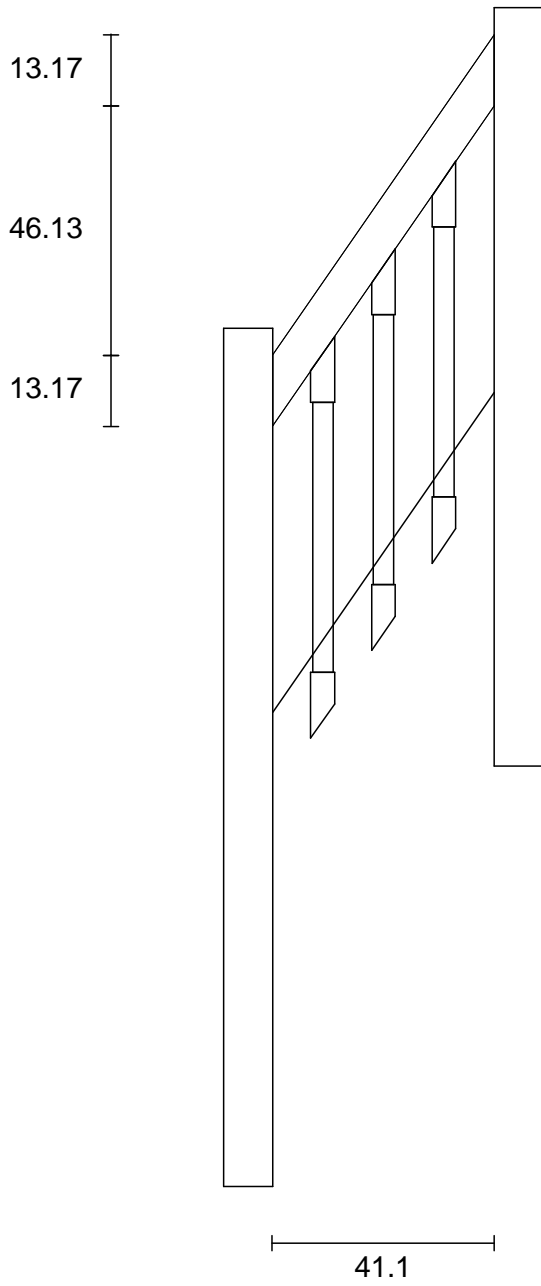

StairDesigner
Pasamanos : 1-3

Sicam

Escalera de Javier Lopez

Pasamanos : 1

Tramo : 1

Posición : 38.28

Altura del Suelo : 56.4

Angulo : 51.13

Altura : 75.54

Diametro del Fuste : 3.8

Base Section : 4.4

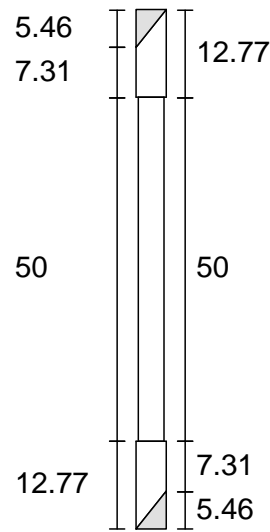

Pasamanos : 2

Tramo : 1

Posición : 51.85

Altura del Suelo : 73.24

Angulo : 51.13

Altura : 75.54

Diametro del Fuste : 3.8

Base Section : 4.4

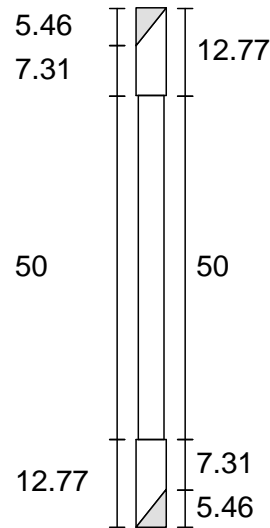

Pasamanos : 3

Tramo : 1

Posición : 65.43

Altura del Suelo : 90.08

Angulo : 51.13

Altura : 75.54

Diametro del Fuste : 3.8

Base Section : 4.4

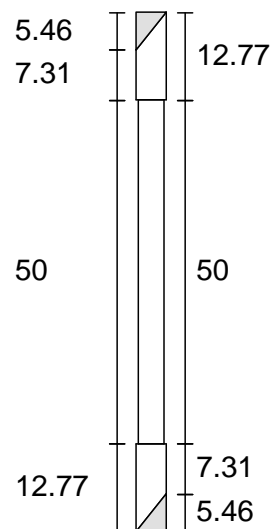

StairDesigner
Pasamanos : 4-6

Sicam

Escalera de Javier Lopez

Pasamanos : 4

Tramo : 2

Posición : 17.34

Altura del Suelo : 153.15

Angulo : 52.38

Altura : 73.96

Diametro del Fuste : 3.8

Base Section : 4.4

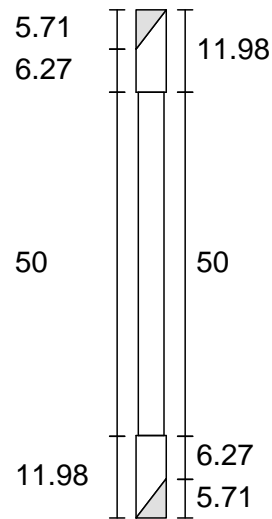

Pasamanos : 5

Tramo : 2

Posición : 32.08

Altura del Suelo : 172.28

Angulo : 52.38

Altura : 73.96

Diametro del Fuste : 3.8

Base Section : 4.4

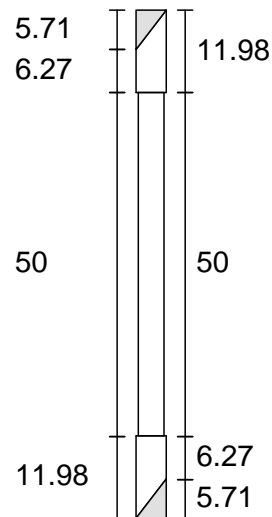

Pasamanos : 6

Tramo : 2

Posición : 46.82

Altura del Suelo : 191.41

Angulo : 52.38

Altura : 73.96

Diametro del Fuste : 3.8

Base Section : 4.4

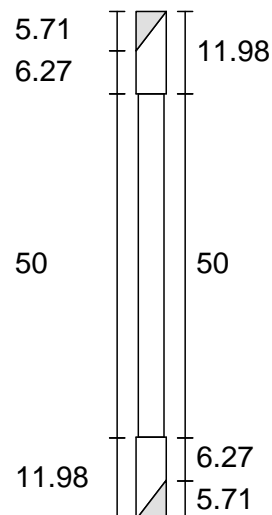

Pasamanos : 7

Tramo : 2

Posición : 61.56

Altura del Suelo : 210.54

Angulo : 52.38

Altura : 73.96

Diametro del Fuste : 3.8

Base Section : 4.4

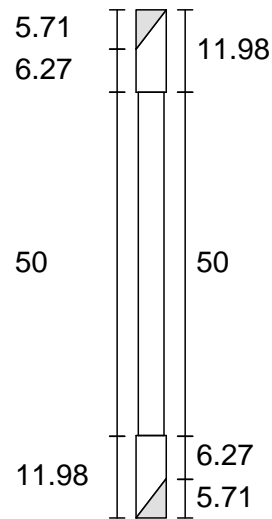

Pasamanos : 8

Tramo : 3

Posición : 13.83

Altura del Suelo : 262.25

Angulo : 55.27

Altura : 74.41

Diametro del Fuste : 3.8

Base Section : 4.4

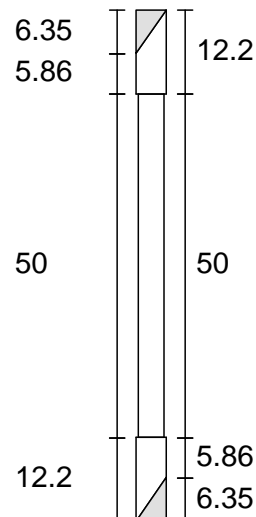

Pasamanos : 9

Tramo : 3

Posición : 25.05

Altura del Suelo : 278.44

Angulo : 55.27

Altura : 74.41

Diametro del Fuste : 3.8

Base Section : 4.4

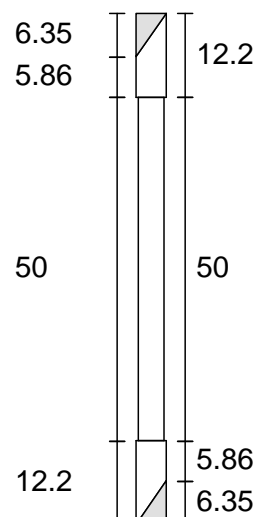

Pasamanos : 10

Tramo : 3

Posición : 36.28

Altura del Suelo : 294.63

Angulo : 55.27

Altura : 74.41

Diametro del Fuste : 3.8

Base Section : 4.4

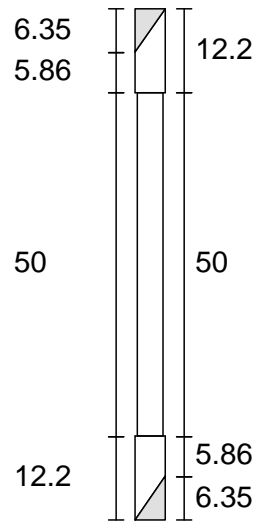

Pieza	Dimensiones	Volumen Bruto	Volumen Neto
Escalon 1	71.68 x 31.85 x 4	0.01 m ³	0.01 m ³
Escalon 2	58.98 x 27.61 x 4	0.01 m ³	0.01 m ³
Escalon 3	61.49 x 30.98 x 4	0.01 m ³	0.01 m ³
Escalon 4	70.84 x 34.75 x 4	0.01 m ³	0.01 m ³
Escalon 5	87.65 x 38.28 x 4	0.01 m ³	0.01 m ³
Escalon 6	78.7 x 31.27 x 4	0.01 m ³	0.01 m ³
Escalon 7	66.18 x 32.01 x 4	0.01 m ³	0.01 m ³
Escalon 8	59.36 x 29.88 x 4	0.01 m ³	0.01 m ³
Escalon 9	64 x 32.83 x 4	0.01 m ³	0.01 m ³
Escalon 10	78.55 x 36.2 x 4	0.01 m ³	0.01 m ³
Escalon 11	92.17 x 35.03 x 4	0.01 m ³	0.01 m ³
Escalon 12	75.81 x 29.72 x 4	0.01 m ³	0.01 m ³
Escalon 13	65.72 x 32.37 x 4	0.01 m ³	0.01 m ³
Escalon 14	58.9 x 11 x 4	0.00 m ³	0.00 m ³
Zanca Derecha 1	185.9 x 35.69 x 5.2	0.03 m ³	0.02 m ³
Zanca Derecha 2	251.81 x 35.47 x 5.2	0.05 m ³	0.03 m ³
Zanca Derecha 3	150.4 x 34.39 x 5.2	0.03 m ³	0.02 m ³
Zanca Izquierda 1	115.22 x 28 x 5.2	0.02 m ³	0.01 m ³
Zanca Izquierda 2	150.86 x 28 x 5.2	0.02 m ³	0.02 m ³
Zanca Izquierda 3	112.54 x 28 x 5.2	0.02 m ³	0.01 m ³
Pasamanos Izquierdo 1	89.78 x 7.5 x 5.2	0.00 m ³	0.00 m ³
Pasamanos Izquierdo 2	124.25 x 7.5 x 5.2	0.00 m ³	0.00 m ³
Pasamanos Izquierdo 3	82.96 x 7.5 x 5.2	0.00 m ³	0.00 m ³
Pilar 1	9 x 9 x 131.67	0.01 m ³	0.01 m ³
Pilar 2	9 x 9 x 167.2	0.01 m ³	0.01 m ³
Pilar 3	9 x 9 x 159.01	0.01 m ³	0.01 m ³
Pilar 4	9 x 9 x 140.37	0.01 m ³	0.01 m ³
Pasamanos 1	4.4 x 4.4 x 75.54	0.00 m ³	0.00 m ³
Pasamanos 2	4.4 x 4.4 x 75.54	0.00 m ³	0.00 m ³
Pasamanos 3	4.4 x 4.4 x 75.54	0.00 m ³	0.00 m ³
Pasamanos 4	4.4 x 4.4 x 73.96	0.00 m ³	0.00 m ³
Pasamanos 5	4.4 x 4.4 x 73.96	0.00 m ³	0.00 m ³
Pasamanos 6	4.4 x 4.4 x 73.96	0.00 m ³	0.00 m ³
Pasamanos 7	4.4 x 4.4 x 73.96	0.00 m ³	0.00 m ³
Pasamanos 8	4.4 x 4.4 x 74.41	0.00 m ³	0.00 m ³
Pasamanos 9	4.4 x 4.4 x 74.41	0.00 m ³	0.00 m ³
Pasamanos 10	4.4 x 4.4 x 74.41	0.00 m ³	0.00 m ³

Pieza	Volumen Bruto	Volumen Neto	Peso	Coste
Escalones	0.12 m ³	0.09 m ³	44.03 kg	37.43 €
Zancas	0.16 m ³	0.12 m ³	58.64 kg	48.89 €
Pasamanos	0.01 m ³	0.01 m ³	5.21 kg	3.47 €
Pilares	0.05 m ³	0.05 m ³	24.23 kg	14.54 €
Balaustres	0.01 m ³	0.01 m ³	5.21 kg	4.33 €
Total	0.36 m³	0.27 m³	137.32 kg	108.66 €